



MODEL:

Delabie DLB-D5106

DELABIE



Delabie 1/2-inch Dome Head Sink Tap with 150mm Swivel Spout

Connection(s): 1/2-inch
Controls: Dome
Mount: Deck mounted
Pedestal: Single Hole
Spout: 150mm swivel
Tap Type: Sink

FEATURES & BENEFITS

- Pillar tap with Long-Life valve head.
- DELTA chrome-plated control knob.
- H. 190mm, L. 150mm.
- Scale-resistant flow straightener regulated to 3 lpm.
- Body and spout in chrome-plated brass.

TECHNICAL INFO

- Connection(s): M1/2-inch.
- Height: 190mm.
- Length: 150mm.
- Flow rate: 3 lpm.

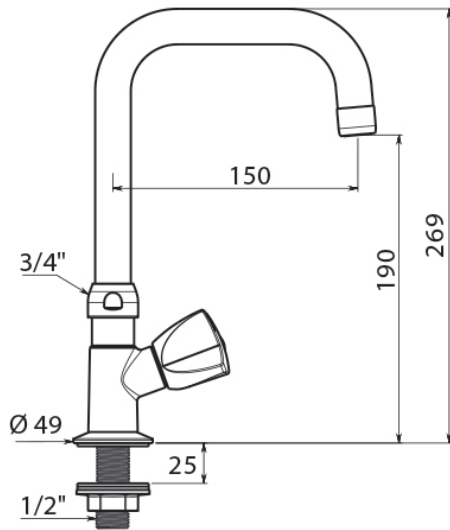

Dimensions are in millimeters. If a Cad file is required please visit www.mechline.com.



MECHLINE DEVELOPMENTS LIMITED

Tel: +44 (0)1908 261511 | Email: info@mechline.com | Web: www.mechline.com