



MODEL:

Delabie DLB-1962284

DELABIE

Delabie Fixed, Cast Spout

Mount: Deck mounted**Spout:** Fixed Spout**FEATURES & BENEFITS**

- Spout L. 140mm, H. 120mm, M½-inch.
- Reinforced fixing by 3 stainless steel screws.
- Chrome-plated solid brass.
- Flow straightener pre-set at 3 lpm.

TECHNICAL INFO

- Connection(s): M½-inch.
- Height: 120mm.
- Length: 140mm.
- Flow straightner regulated to 3 lpm.
- Product material: Chrome plated brass
- Max recommended temperature 60°C
- Product weight: 0.71kg

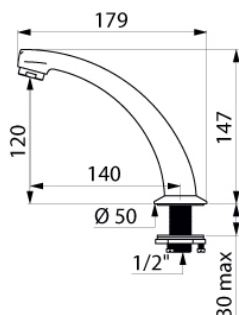

Dimensions are in millimeters. If a Cad file is required please visit www.mechline.com.



MECHLINE DEVELOPMENTS LIMITED

Tel: +44 (0)1908 261511 | Email: info@mechline.com | Web: www.mechline.com