



MODEL:

**AquaTechnix TX-B-3SG6L**

# AQUATECHNIX

AquaTechnix LEVER operated faucet TX-B-30 base with 150mm swivel gooseneck spout. H: 329mm

**Accreditation:** Kiwa KUKreg4 1+

**Tap Hole Centres:** 180mm

**Base:** TX-B-30

**Connection(s):** ½-inch

**Controls:** Lever

**Model Range:** TX-30

**Mount:** Deck mounted

**Pedestal:** Twin Hole

**Spout:** 150mm swivel gooseneck

**Tap Type:** Twin Mixer

**Water Feed:** Twin

## FEATURES & BENEFITS

- Ergonomic in design and functionality.
- Modern, hygienic and practical design comes pre-assembled ready to install.
- All assembled models are factory tested up to 6 bar for quality assurance.
- Includes PosiStop protected lever and dome heads for long life and reliability for all models
- Water saving diffuser included as standard

## TECHNICAL INFO

- Connection(s): ½-inch BSP male threads at 55mm length including non-return valves
- Height: 314mm
- Hole cut out requirement: 25-27mm at 180mm centres
- Product material: nickel plated brass
- Product weight: 1.53kg
- Recommended working pressure: 1.5 - 5 bar
- Flow rates: standard diffuser 9.33 lpm water saving diffuser 3.7 lpm tested at 3 bar pressure
- Certified to KUK Reg4 1+ by Kiwa
- Max recommended temperature 60°C

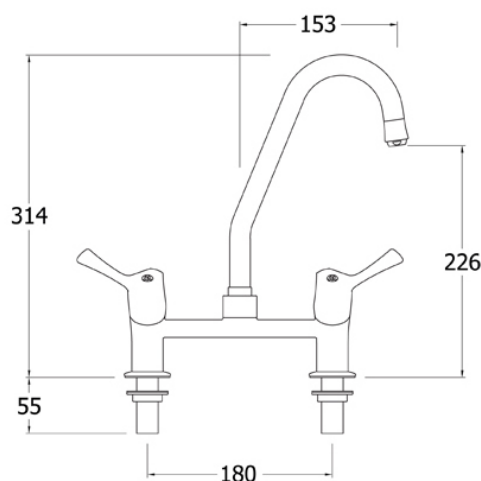

Dimensions are in millimeters. If a Cad file is required please visit [www.mechline.com](http://www.mechline.com).



MECHLINE DEVELOPMENTS LIMITED

Tel: +44 (0)1908 261511 | Email: [info@mechline.com](mailto:info@mechline.com) | Web: [www.mechline.com](http://www.mechline.com)